

Spreader Control Adapter Kit for Cup Holder Mount

INSTALLATION INSTRUCTIONS

⚠ WARNING

Do not exceed GVWR or GAWR ratings as found on the driver-side vehicle door cornerpost.

⚠ CAUTION

Read this document before installing the spreader control cup holder mount kit.

⚠ CAUTION

Use standard methods and practices when attaching spreader and installing accessories, including proper personal protective safety equipment.

1. Park the vehicle on a smooth, level, hard surface, such as concrete. Turn the vehicle ignition to the "OFF" position and remove the key.
2. Position the spreader control mount plate to the joystick snowplow control adapter and align holes as shown. Secure with four #8 x 1/2" screws and #8 nuts. The screw head must be facing up as shown.
3. Position the spreader control mount plate to the bottom of the spreader control and align the holes in the mount plate to the threaded inserts in the spreader control. Secure with four #8 x 1/2" screws.
4. Attach the spreader control to the cup holder mount. Plug in the spreader control harness.

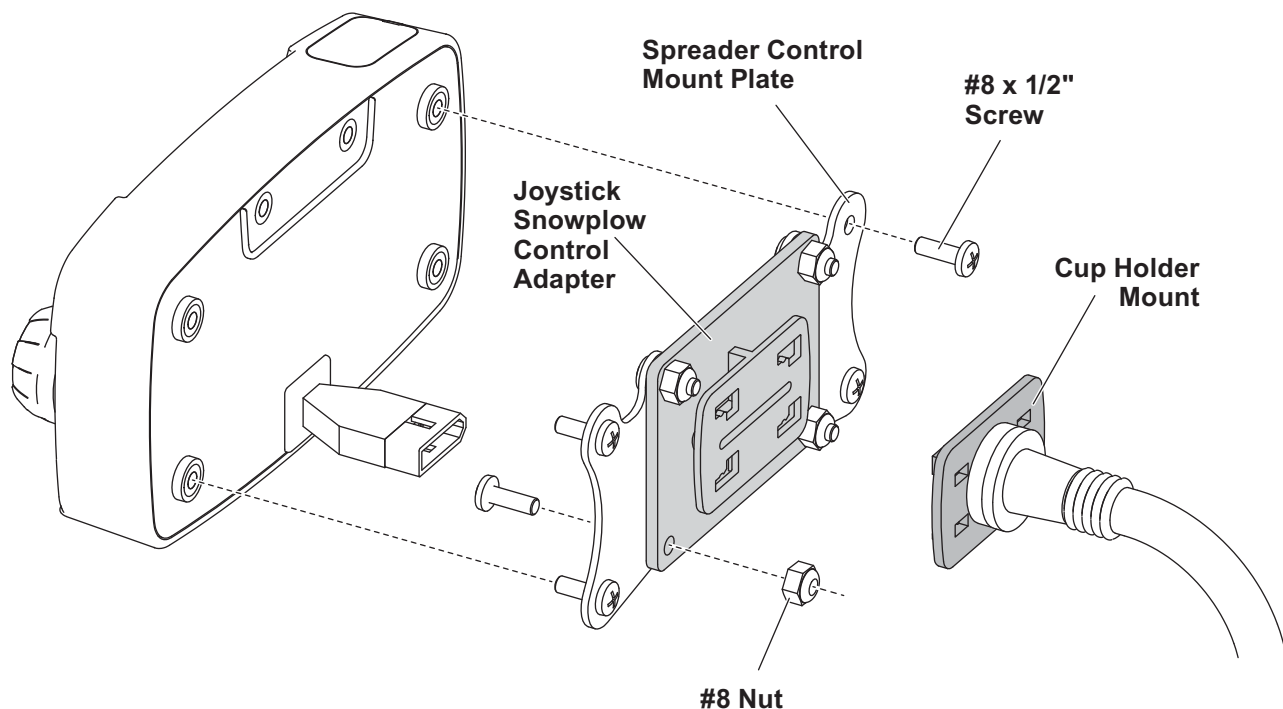

The company reserves the right under its product improvement policy to change construction or design details and furnish equipment when so altered without reference to illustrations or specifications used. This equipment manufacturer or the vehicle manufacturer may require or recommend optional equipment for spreaders. Do not exceed vehicle ratings with a spreader. The company offers a limited warranty for all spreaders and accessories. See separately printed page for this important information.

Printed in U.S.A.
