

Assembly Instructions

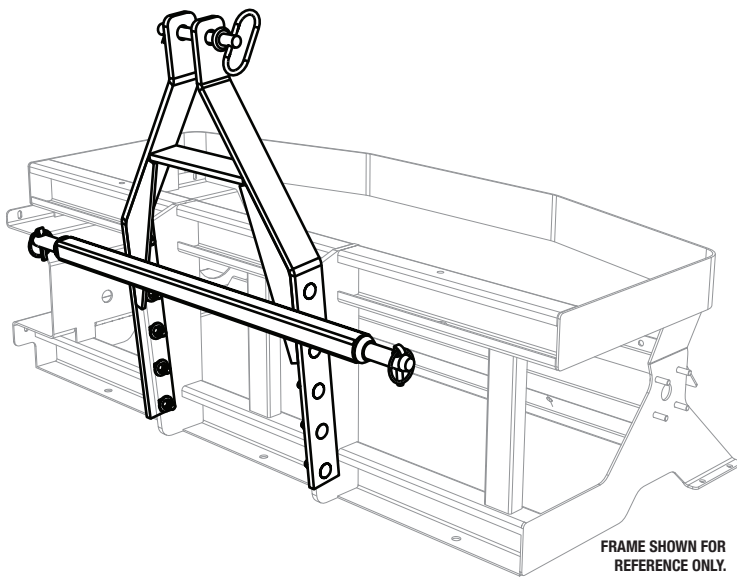

TPD-020

FRAME SHOWN FOR
REFERENCE ONLY.



CUSTOMER COPY

Madison Heights, Michigan 48071
800-SALTERS
www.snowexproducts.com

TORQUE CHART

Use this chart as a guide for tightening hardware.

Hand-tighten all fasteners until complete, then tighten to the recommended torque (unless specified otherwise in these instructions).

TORQUE CHART FT-LB	
Fastener	Recommended Torque (ft-lb)
1/4-20	6
5/16-18	13
3/8-16	23
7/16-14	35
1/2-13	55
9/16-12	80
5/8-11	110
3/4-10	200
7/8-9	320
1-8	480

ASSEMBLY INSTRUCTIONS

1. Fit the 'A-Frame' over the tabs on the spreader frame.

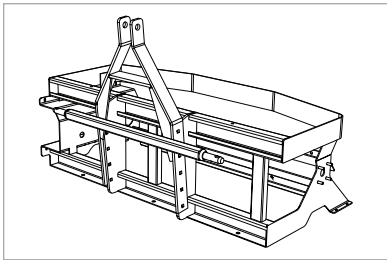

2. Align the bolt holes; fit the bolts through from the outside.

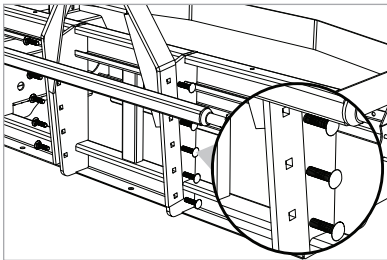

3. Put a washer and nut on each bolt. Tighten, ensuring the shank of the carriage bolt is seated inside the square hole.
4. Put the Top Link Pin with Hitch Pin, and Linchpins into their respective places, ready for use.

