

## Adjustment Plate Kit

### RDV™ Snowplows

#### PARTS LIST

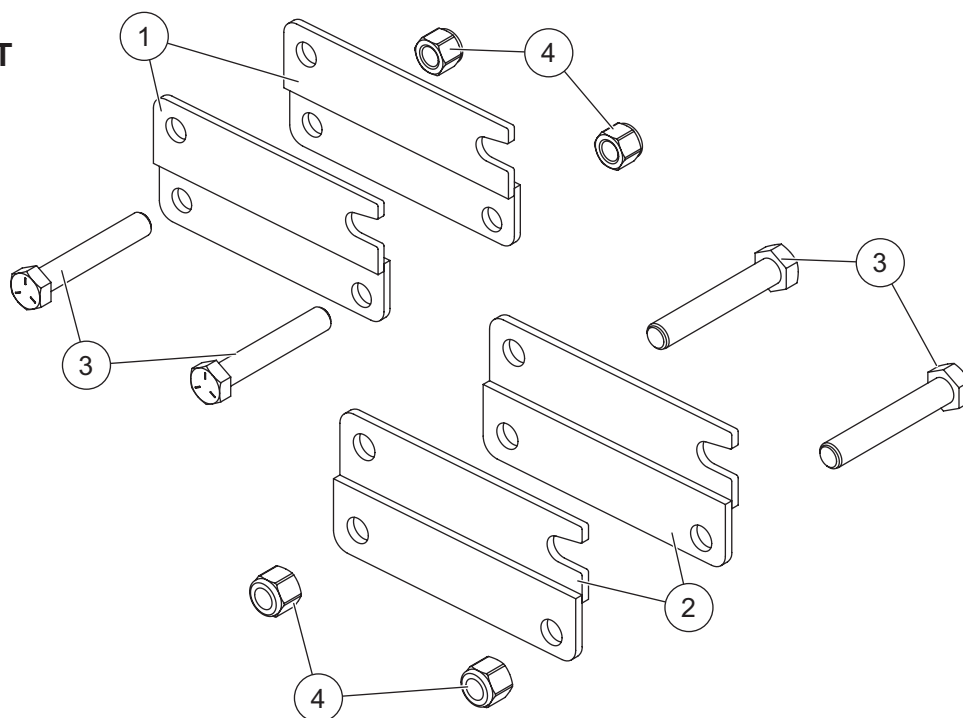

85395 Adjustment Plate Kit							
Item	Part	Qty	Description	Item	Part	Qty	Description
1	85393	2	Height Adjustment Plate DS	3		4	3/4-10 x 4-1/2 Hex Cap Screw G5
2	85394	2	Height Adjustment Plate PS	4		4	3/4-10 Hex Locknut GB
G = Grade							

#### ⚠ WARNING

Do not exceed GVWR or GAWR, including blade and ballast. The rating label is found on the driver-side vehicle door cornerpost.

#### ⚠ CAUTION

Read this document before installing the adjustment plate kit.

#### ⚠ CAUTION

Use standard methods and practices when attaching snowplow and installing accessories, including proper personal protective safety equipment.

#### ⚠ CAUTION

See your SnowEx<sup>®</sup> outlet/Web site for specific vehicle application recommendations before installation. The Power Match selection system has specific vehicle and snowplow requirements.

## INSTALLATION INSTRUCTIONS

1. Park the vehicle on a smooth, level, hard surface, such as concrete.
2. Measure the distance "d" from the ground to the center of the hole in the vehicle mount. Measure the distance on both sides of the vehicle and determine average value for "d."

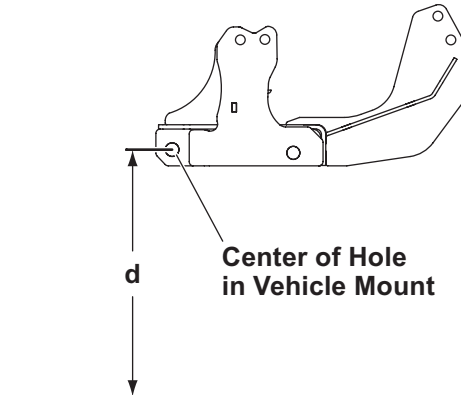

3. Use distance "d" from Step 1 and the following chart to determine the proper T-frame hole.

T-Frame Hole Chart	
Distance "d"	Hole
16.75" – 18.0"	1*
15.5" – 16.75"	2*
14.25" – 15.5"	1
13.0" – 14.25"	2
11.75" – 13.0"	3

\* For these measurements and holes, the adjustment plate kit is required in addition to standard receivers.

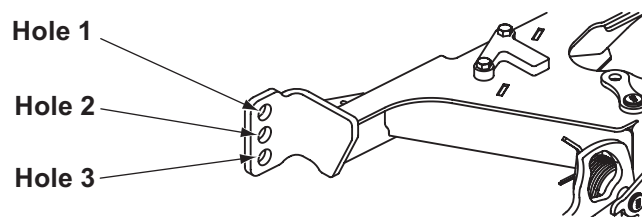

4. If required, install adjustment plates as follows, keeping the receivers toward the center of the vehicle: Position an adjustment plate on each side of the receiver as shown. Insert a 3/4" x 4-1/2" cap screw through the lower front adjustment plate hole and through the appropriate hole on the receiver. Secure with a 3/4" locknut.

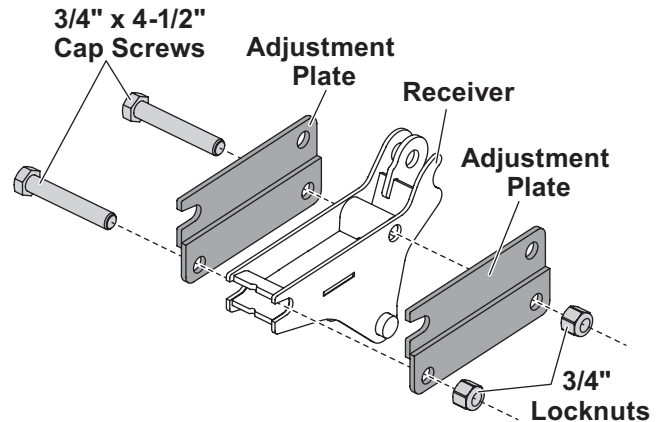

Insert a cap screw through the rear adjustment plate hole, through the slot on the receiver. Secure with a locknut.

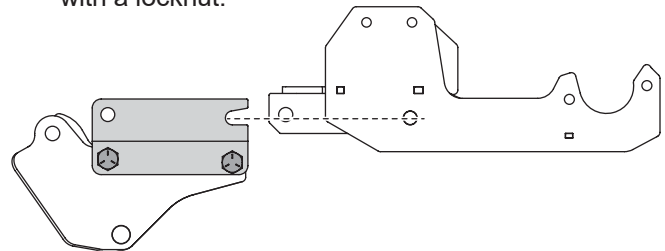

Repeat for the opposite side. Tighten all fasteners to 269 ft-lb.

5. Position the T-frame between the headgear strut and inner ear, aligned with the appropriate T-frame hole (from Step 3).
6. On each side, insert a 3/4" x 3-1/4" clevis pin (from the shipping bracket) from the outside of the headgear through the correct T-frame hole. Secure the clevis pins with 5/32" x 1-1/2" cotter pins.

Copyright © 2022 Douglas Dynamics, LLC. All rights reserved. This material may not be reproduced or copied, in whole or in part, in any printed, mechanical, electronic, film, or other distribution and storage media, without the written consent of TrynEx International, LLC. Authorization to photocopy items for internal or personal use by TrynEx International outlets or snowplow owner is granted.

TrynEx International reserves the right under its product improvement policy to change construction or design details and furnish equipment when so altered without reference to illustrations or specifications used. TrynEx International or the vehicle manufacturer may require or recommend optional equipment for snow removal. Do not exceed vehicle ratings with a snowplow. TrynEx International offers a limited warranty for all snowplows and accessories. See separately printed page for this important information. The following are registered (®) or unregistered (™) trademarks of Douglas Dynamics, LLC: Automatix®, RDV™, SnowEx®.

Printed in U.S.A.