

Loader Attachment Plates

Steel Trip Edge Pusher Plows

PARTS LIST

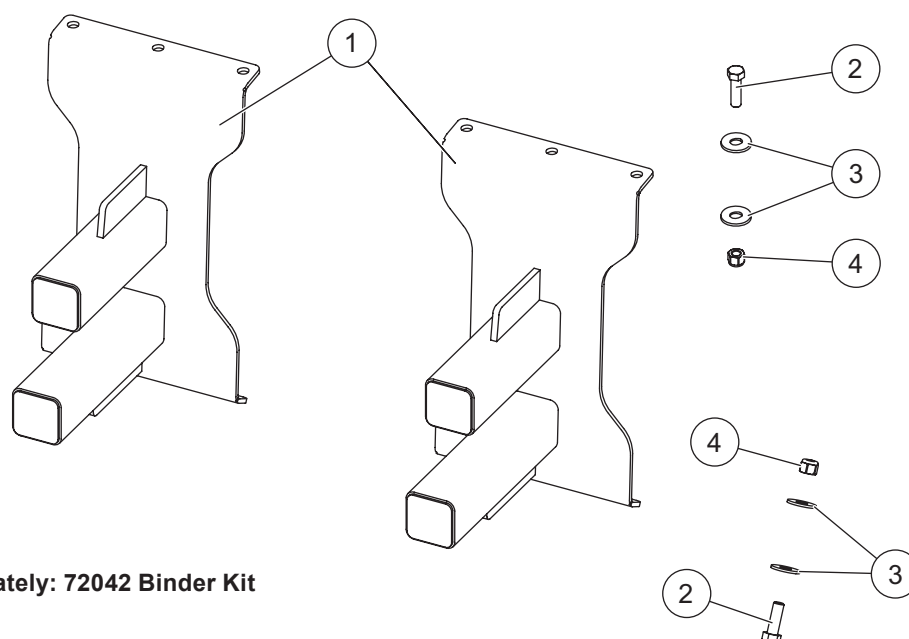

Available separately: 72042 Binder Kit

79361 Loader Attachment Plates Kit							
Item	Part	Qty	Description	Item	Part	Qty	Description
1	72895	2	Loader Attachment Plate	ns	79359	1	Bolt Bag
79359 Bolt Bag							
2		12	1/2-13 x 1-1/2 Hex Cap Screw G5	4		12	1/2-13 Hex Locknut GB
3		24	1/2 Flat Washer				
ns = not shown				G = Grade			

⚠ WARNING

Do not exceed GVWR or GAWR, including blade and ballast.

⚠ CAUTION

Read this document before installing the loader attachment plates.

⚠ CAUTION

Use standard methods and practices when attaching snowplow and installing accessories, including proper personal protective safety equipment.

INSTALLATION INSTRUCTIONS

Install the loader attachment plates to the coupler mounting hubs on the back of the blade using a 1/2" x 1-1/2" cap screw, two 1/2" flat washers, and a 1/2" locknut at each mounting hole, as shown. Tighten fasteners to 75 ft-lb.

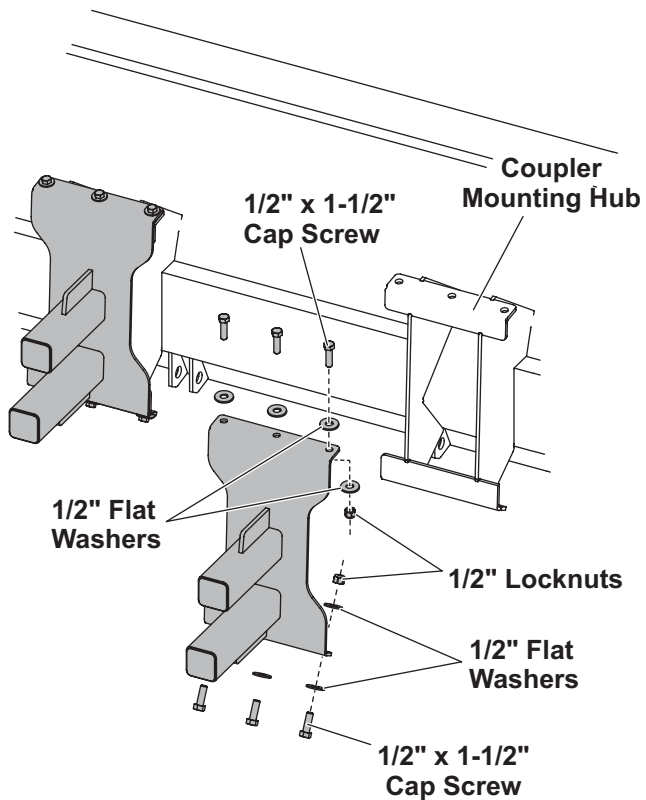

ATTACHING SNOWPLOW TO LOADER

The Binder Kit (PN 72042, sold separately) must be used for bucket loader installations.

1. Guide the leading edge of the loader bucket into the 2-post receptacles on the attachment plates.

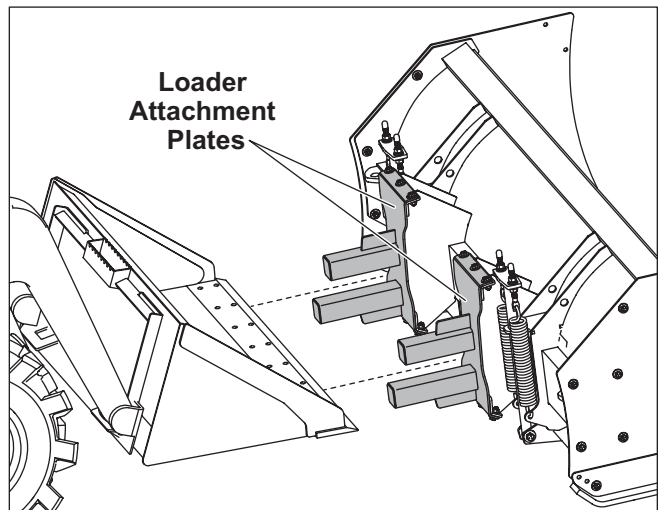

2. The bucket edge will rest against the attachment plates. The upper posts will fit inside the bucket and should be centered. The lower posts will be positioned under the bucket.

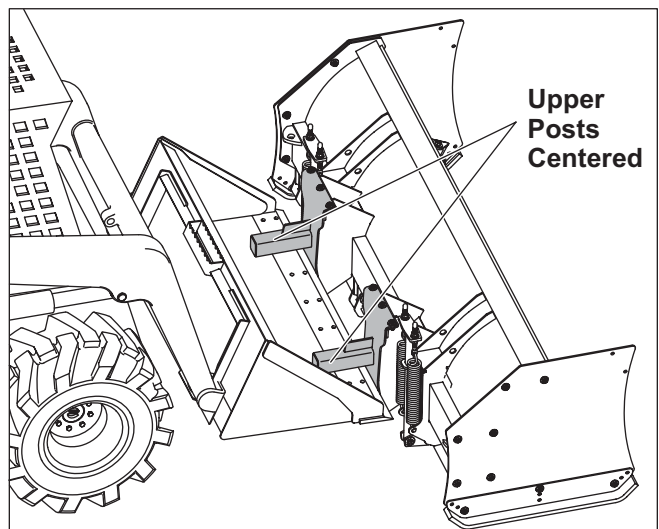

3. Attach the chains and ratchet binder to secure the plow to the bucket, as described in the next section.

Install Chains and Ratchet Binder

1. Weld the 2 supplied grab hooks onto the sides or back corners of the loader bucket. Make sure to choose locations where the hooks will be level with the chain attachment points on the back of the pusher plow. This will ensure that the installed chains will be parallel to the ground, which makes it easier to center the plow on the loader bucket.

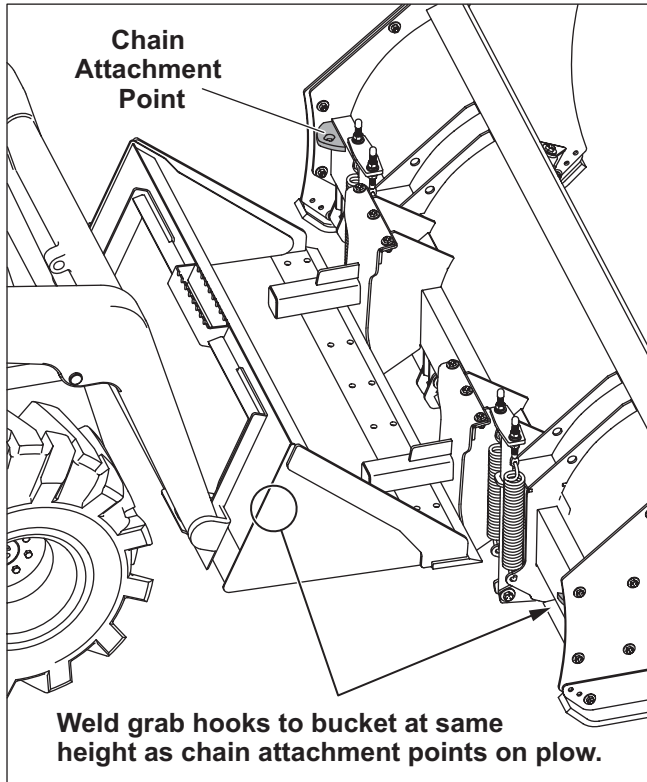

2. Use a supplied clevis attachment to connect one of the supplied chains to the attachment point on one side of the pusher plow. Drop the other end of the chain into the welded-on grab hook. Leave enough slack to allow for centering the pusher plow on the loader bucket.

Repeat on the opposite side of the snowplow using the second length of chain.

3. Raise the bucket to lift the plow off the ground. Add or remove slack in the chains as necessary to center the plow on the bucket, making sure one of the chains is pulled taut.
4. Using the supplied ratchet binder, take up the remaining slack in the second chain.

Copyright © 2019 Douglas Dynamics, LLC. All rights reserved. This material may not be reproduced or copied, in whole or in part, in any printed, mechanical, electronic, film, or other distribution and storage media, without the written consent of the company. Authorization to photocopy items for internal or personal use by the company's outlets or snowplow owner is granted.

The company reserves the right under its product improvement policy to change construction or design details and furnish equipment when so altered without reference to illustrations or specifications used. This equipment manufacturer or the vehicle manufacturer may require or recommend optional equipment for snow removal. Do not exceed vehicle ratings with a snowplow. The company offers a limited warranty for all snowplows and accessories. See separately printed page for this important information.

Printed in U.S.A.